

10D8N

CHARMS OF THE

日本・

东 & TOHOKU & 北 北 北海道

TOKYO | TOCHIGI | AIZUWAKAMATSU | SENDAI
| AOMORI | HAKODATE | TOYAKO | OTARU | SAPPORO

东京 | 栃木 | 会津若松 | 仙台 | 青森 | 函馆 | 洞爷湖
| 小樽 | 札幌 |



Ginzan Onsen
银山温泉

thesignaturetours.com

TC • 10SJCTS



By The Signature Tours 由卓越旅程团队 Travel Designer Team 给您的游玩宝典



Dear Valued Guest,

Discover the hidden charm of Tohoku & Hokkaido, where history, nature, and culture come together in perfect harmony. Our exclusive tour takes you beyond the usual routes to explore the unique beauty of Tohoku and Hokkaido in every season.

Starting from Tokyo, visit Toshogu Shrine and Kegon Falls in Tochigi, stroll through the historic streets of Ouchi-juku, and marvel at the snow monsters of Zao. Experience the tranquility of Ginzan Onsen, the scenic beauty of Matsushima Bay, and the romantic landscapes of Hakodate and Furano.

Enjoy handpicked accommodations & onsen experiences, blending relaxation with adventure. No matter the season, unforgettable memories await.

Join us and experience the magic of Tohoku & Hokkaido!

亲爱的旅客，

日本的东北与北海道是一片充满故事的土地，这里有千年的文化沉淀、奇幻的自然景观和静谧的温泉小镇。此次“北境奇韵”之旅，我们为您设计了远离传统路线的独家行程，带您全方位探索北日本独特魅力，无论春夏秋冬，都能收获不同的感动。

从东京出发，探访栃木的东照宫与华严瀑布，感受自然与历史的辉映；走进会津若松的大内宿，体验古老街区的独特韵味。藏王的雪怪奇景、松岛湾的绝美海天、银山温泉的幽静夜色，将展现北日本的自然奇观。而函馆的璀璨夜景与富良野的诗意花田，更为行程增添浪漫色彩。

全程甄选特色住宿与私密温泉体验，结合多元化景点安排，让您轻松沉浸于北日本的风光与文化。无论您选择哪个季节出行，每一刻都将是难忘的记忆。

加入我们，用脚步丈量北境，感受四季流转中的奇韵风华！



Lake Toyako
洞爷湖展望台



Map 地图





Hokkaido Jingu
北海道神宮

10D 8N

CHARMS OF THE TOHOKU & HOKKAIDO

TOKYO | TOCHIGI | AIZUWAKAMATSU | SENDAI | AOMORI |
HAKODATE | TAYOKO | OTARU | SAPPORO |

DAY 01 KUL ✈️ TOKYO

DAY 02 TOKYO – 107KM – TOCHIGI (LL/HD)

- Arrive in capital of Japan, Tokyo.
- Tokyo city tour: **Odaiba Marine Park, Tokyo Bay, Rainbow Bridge, Statue of Liberty**
- **Toyosu Senkyaka Banrai** : A place where Japanese cuisine, fresh seafood, snacks etc., can be found.
- Check-in to Onsen Hotel and enjoy hot spring!

DAY 03 TOCHIGI – 203KM – AIZUWAKAMATSU (HB/LL/HD)

- **Nikko Toshogu Shrine**: Enshrines the most famous samurai leader Tokugawa Ieyasu. Famous for its splendid architecture and intricate carvings.
- **Kegon Waterfalls**: known as one of Japan's top three greatest waterfalls.
- **Ouchi-juku**: A well-preserved Edo-period post town where visitors can experience traditional Japanese rural charm, featuring numerous craft shops and food stalls.

DAY 04 AIZUWAKAMATSU – 170KM – SENDAI (HB/LL/LD)

- Board the **Matsushima Bay Cruise** for a mesmerizing experience with crystal-clear islands dotting the serene blue bay.
- ***Seasonal Attraction***
March to November
- **Goshikinuma Ponds** – A stunning group of ponds located within Bandai-Asahi National Park. A popular natural attraction renowned for its vibrant and unique colored water.
- **Risshaku-ji**: One of the most significant Buddhist temples in Yamagata Prefecture, Japan, famous for its distinctive stone architecture and magnificent natural surroundings.
- **December to February**
- **Zao Snow Monster** – Visit to Mt. Zao to see the unique winter natural phenomenon.

DAY 05 SENDAI – 63KM – YAMAGATA – 154KM – (HB/LL/HD) MORIOKA

- **JR Fruit Park Sendai Arahama**: Offers opportunity to pick fresh fruits throughout the year, while enjoying the pleasure of close contact with nature.
- ***Fruits of Different Seasons:**
 - Spring (April-June): Strawberries
 - Summer (July-August): Peaches, Grapes
 - Autumn (September-November): Apples
- ***During off-seasons, fruits of equal value are provided from supermarkets.**
- **Ginzan Onsen Town**, with a history spanning 500 years, serves as the iconic heart of Ginzan Onsen.
- Visit the UNESCO World Heritage **Chūson-ji Temple** to admire its most famous structure, **Konjikido**, an impressive collection of Buddhist artifacts and statues.

Meal Codes:

*MOB=Meals on Board/HB=Hotel Breakfast/LL=Local Lunch/LD=Local Dinner
HD= Hotel Dinner

Exclusive Arrangement

Disclaimer:

Sequences of itinerary are subject to local arrangement. Itineraries, meals, hotels and transportation are subject to change without prior notice.

DAY 06 MORIOKA – 182KM – AOMORI (HB/LL/LD)

- **Lake Towada**: One of the deepest lakes in Japan, formed by volcanic activity, featuring a unique double-caldera shape and breathtaking scenery. The lake's outlet connects to the **Oirase Gorge**, a picturesque valley renowned for its waterfalls and crystal-clear streams.
- **Aomori Prefectural Tourist Product Center (ASPAM)**: A symbolic landmark of Aomori City, featuring a unique triangular design that represents the letter "A" for Aomori.

DAY 07 AOMORI – 1.5HRS – HAKODATE (HB/LL/HD)

- **Goryokaku**: A star-shaped Western-style fortress in Hakodate, Japan, originally built in the 19th century as a military stronghold. Now it's a park.
- ***Early May is the peak season for cherry blossoms.**
- **Kanemori Red Brick Warehouses**: Built during Meiji era & were used as port warehouses.
- **Mount Hakodate**: Take a cable car to the top of the mountain and enjoy one of the world's top 3 nightscapes.

DAY 08 HAKODATE – 164KM – TOYAKO – 102KM (HB/LL/LD) – OTARU – 38KM – SAPPORO

- **Hakodate Asaichi**: Hakodate's local delicacies, handmade crafts and souvenirs can be found here.
- **Lake Toya Observation Deck**: Overlooks the entire lake surrounds by mountains, and exquisite views of the volcanic Mount Usu and Showa Shinzan.
- **Otaru Glass**: Otaru is known for its refined glass craftsmanship. Here it showcases a variety of beautiful glass art pieces.

DAY 09 SAPPORO (HB/LL/LD)

- **Odori Park**: A central urban park in Sapporo that divides the city into northern and southern sections and is a vibrant hub for relaxation, recreation, and major events throughout the year.
- Enjoy strolling around **Tanuki Koji**, Sapporo's famous shopping street.
- *** Seasonal Attraction***
Mid-August to May
- **Hokkaido Jingu**: An important Shinto shrine in Sapporo, dedicated to the pioneers of Hokkaidō and their spirit.
- ***A prime spot for cherry blossom s in early May.**
- **June to mid-August**
- **Sapporo – 113KM – Furano – 113KM – Sapporo**
- **Furano Flower Fields**: Its summer lavender fields and vibrant flower landscapes are breathtakingly beautiful.

DAY 10 SAPPORO ✈️ KUALA LUMPUR

- Depart back home

***Winter Optional activity** - Experience the famous Hokkaido snowmobile ride, gliding across snow-covered fields under a flurry of falling snow.
**Single seater: Approximately JPY13000
**Two-seater: Approximately JPY18000



Kagon Waterfalls
华严瀑布

10天 8晚

日本·东北与北海道

东京 | 栃木 | 会津若松 | 仙台 | 青森 | 函馆 | 洞爷湖 | 小樽 | 札幌 |

第01天 吉隆坡 ➔ 东京

第02天 东京 - 107KM - 栃木 (道地午餐/酒店晚餐)

- 抵达日本首都，东京。
- 东京市区观光：台场海滨拍照，东京湾，彩虹桥，自由女神像
- 豊州千客万来 -可以在这里的美食广场找到日本传统料理，海鲜，零食等。集购物，美食，文化活动和休闲娱乐于一体的场所。
- 入住温泉酒店，享受温泉！

第03天 栃木 - 203KM - 会津若松 (酒店早餐/道地午餐/酒店晚餐)

- 世界遗产东照宫：德川家康的灵位所在，以华美建筑和精致雕刻闻名，是日本文化的象征。
- 华严瀑布：日本三大瀑布之一，四季变化带来不同风貌。
- 大内宿：保存完好的江户时代宿场町，可以体验传统文化的日本乡村风情，有许多手工艺品店和美食摊位。

第04天 会津若松 - 170KM - 仙台 (酒店早餐/道地午餐/道地晚餐)

- 松岛游船 - 被誉为“日本三景”之一，晶莹的小岛与蔚蓝海湾令人陶醉。

季节安排

3月至11月

- 五色沼 - 位于日本福島县磐梯朝日国立公园内的一片美丽的湖沼群。它因独特的湖水颜色而得名，因而非常有名。
- 立石寺 - 日本山形县最重要的佛教寺院之一，以独特的石头建筑和宏伟的自然景观而闻名。

12月至2月

- 藏王雪怪 - 藏王山地特有的冬季自然现象。它是一种由强风和冰雪共同作用形成的独特景观，类似“雪怪”或“冰雪巨人”的形状，因而得名。藏王山也是冬季滑雪的理想地点。

第05天 仙台市 - 63KM - 山形 (酒店早餐/道地午餐/酒店晚餐)

- 154KM - 盛岡

- JR果园公园：为游客提供了一年四季都能体验采摘新鲜水果的机会，同时还能享受与大自然亲密接触的乐趣。

*不同季节的水果

- 春季 (4-6月)：草莓
- 夏季 (7-8月)：桃子，葡萄
- 秋季 (9-11月)：苹果

*没有水果的季节，到超市送同价值水果

- 银山温泉乡拥有500年历史的银山温泉的“脸面”，是寻幽探秘、领略古代日本风情的理想地点。
- 到世界遗产中尊寺，参观这里最著名的建筑 - 金色唐。金色唐内部保存着丰富的佛教艺术品和佛像，是日本佛教建筑的杰作之一。

第06天 盛岡- 182KM - 青森 (酒店早餐/道地午餐/道地晚餐)

- 十和田湖：是日本最深的湖之一，因火山喷发而形成，湖面呈现独特的双层圆形，景色壮观。十和田湖的出水口连接着奥入濑溪流，这是一条风景如画的溪谷，以其瀑布和清澈溪水吸引着无数游客。秋天的红叶美景令人陶醉。
- 青森县观光物产馆：青森市的标志性建筑，呈现独特的三角形设计，象征t青森的首字母“A”。汇聚了青森特产和文化的综合中心。

第07天 青森 - 1.5HRS - 函馆 (酒店早餐/道地午餐/酒店晚餐)

- 五棱郭：一座五角星形的西式城堡遗址，是日本首座依据西方堡垒设计理念建造的军事要塞，用于防御外敌入侵。如今已成为一座公园。*5月初旬为樱花盛地
- 金森红砖仓库群：建于明治时代的红砖建筑，原本用作港口仓库，现在经过改造，成为集购物、餐饮、艺术展览等功能于一体的观光区。
- 函馆山：乘坐缆车登上山顶，欣赏世界三大夜景之一。

第08天 函馆- 164KM - 洞爷湖 (酒店早餐/道地午餐/道地晚餐)

102KM - 小樽- 38KM - 札幌

- 函馆朝市：可以在这里品尝到函馆的特色美食并购买当地手工艺品和纪念品。
- 洞爷湖展望台：观赏洞爷湖美丽景色的绝佳地点。可以俯瞰到整个洞爷湖的壮丽景观，湖水清澈，四周被群山环抱，尤其能看到火山有珠山和昭和新山的景色。
- 小樽玻璃工艺馆：小樽以其精美的玻璃工艺而闻名，博物馆内展示了许多精美的玻璃艺术品。

第09天 札幌 (酒店早餐/道地午餐/道地晚餐)

- 大通公园：大型城市公园，贯穿主要商业区，市民和游客休闲、娱乐的重要场所。并眺望札幌电视塔。
- 到札幌市的著名商业街狸小路闲逛。

季节安排

8月中旬-5月

- 北海道神宫：是札幌市的一座重要神社，是祭祀北海道开拓者及其精神的地方。*5月初旬为樱花盛地。

6月-8月中旬

札幌 - 113KM - 富良野 - 113KM - 札幌

- 富良野花田：夏季的薰衣草田，五彩缤纷的花海，惊艳人心。

第10天 札幌 ➔ 吉隆坡

免责声明:

行程次序以当地旅行社安排为准。行程，膳食，住宿，交通等可能会因不可抗拒因素而更动，恕不另行通知。

*冬季自费活动 - 体验著名北海道雪车，奔驰于漫天飘雪的雪原

**单人1台：约 JPY13000

**双人1台：约 JPY18000



Aomori Prefectural Tourist Product Center (ASPAM)
青森县观光物产馆

Scenic Excursions



畅游四季风景



五棱郭 Goryokaku

Goryokaku, a historic star-shaped fort in Hakodate, blends history with stunning landscapes. In spring, it's adorned with cherry blossoms; summer brings lush greenery; autumn offers golden hues, and winter blankets it in serene snow.

五棱郭是函馆著名的星形历史遗迹，融合了历史与绝美景观。春季樱花盛开，夏季绿意盎然，秋季金黄灿烂，冬季银装素裹。



富良野花田 Furano Flower Fields

In summer, Furano's flower fields bloom in vibrant colors, with lavender and marigolds creating a dreamy, fragrant landscape.

夏季的富良野花田五彩斑斓，薰衣草、金盏菊等交相辉映，淡淡花香随风飘散，宛如浪漫的紫色梦境。



五色沼 Goshikinuma Ponds

Goshikinuma is a series of volcanic ponds formed by the eruption of Mount Bandai in 1888, known for their stunning, ever-changing colors, ranging from emerald green to cobalt blue.

位于福岛县磐梯朝日国家公园内，是由1888年磐梯山喷发形成的一系列火山湖沼，以其绚丽多变的色彩而闻名，色调从翠绿色到深蓝色不等



世界最特别的雪上奇景 - 藏王雪怪

World's Most Unique Snow Phenomenon - Zao Snow Monsters

The Zao Snow Monsters are a unique natural phenomenon found in Japan's Zao Mountain Range. These "snow monsters" are trees covered in heavy snow and ice, shaped into eerie and mystical forms by strong winds.

藏王雪怪是一种独特的自然现象，出现在日本的藏王山脉。这些“雪怪”其实是被厚雪和冰覆盖的树木，经过强风的作用，形成了奇特且神秘的造型，仿佛是来自另一个世界的怪异生物。





Must See Attractions

“世界之最” 深入探索



Carefree
悠游

Enjoy relaxation, truly appreciate the world
享受放松 感慨世界美好

Capture
收获

The color & essence of each journey
旅途中的色彩和精髓

Cozy
温馨

Vibes to create joyful moment together
共创愉悦片刻



世界最引人入胜漫画景点 - 银山温泉



World's Most Captivating Manga-Inspired Destination - Ginzan Onsen

Ginzan Onsen is a picturesque hot spring town in Japan, known for its traditional ryokan inns and historic ambiance. While it is a captivating destination, it is not specifically manga-inspired. However, its charming streets and nostalgic atmosphere have been featured in various media and are reminiscent of scenes from Japanese manga and anime.

银山温泉 是一个风景如画的温泉小镇，以传统的日式旅馆和悠久的历史的氛围而闻名。虽然它并非专门受到漫画启发，但它迷人的街道和怀旧的氛围常常出现在各种媒体中，令人联想到日本漫画和动漫中的场景。

世界三大夜景之一 - 函馆山夜景



World's Top Three Night Views - Mount Hakodate Night View

Mount Hakodate offers one of the most mesmerizing night views in the world. From the summit, the city lights sparkle like stars, while the moonlight reflects off the bay, creating a stunning contrast.

函馆山的夜景是世界上最迷人的景观之一。从山顶俯瞰，城市的灯光如星辰般闪烁，海湾的月光倒映在水面上，周围的山脉和夜空的结合让这一切更加壮丽。



世界遗产东照馆 & 中尊寺



UNESCO World Heritage Tōshōgū Shrine & Chuson-ji

The Toshogu Shrine in Nikko dazzles with intricate carvings and the iconic "Three Wise Monkeys," while Chuson-ji in Hiraizumi captivates with its golden Konjikido Hall, both offering a glimpse into Japan's rich cultural and artistic heritage.

日光东照宫以精美的雕刻和著名的“三猿”闻名，而平泉中尊寺的金色堂则以其辉煌的金箔装饰令人叹为观止，两者共同展现了日本丰富的文化与艺术遗产。

UNESCO World Heritage Site
联合国教科文组织世界遗产



世界最长海底隧道 - 青函海底隧道穿越

World's Longest Undersea Tunnel – Seikan Tunnel Crossing

As you travel from Aomori to Hakodate aboard Japan's high-speed Shinkansen, you'll pass through the Seikan Tunnel, the world's longest undersea tunnel.

乘坐日本高速 新干线 从 青森 到 函馆 的旅程中，将穿越 青函海底隧道，它是世界上最长的海底隧道。

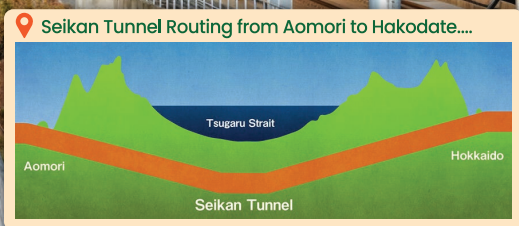

世界最快交通工具-子弹火车体验

World's Fastest Mode of Transportation – Bullet Train Experience

Japan's Shinkansen. Travelling from Aomori to Hakodate, The E5 series Shinkansen reaches speeds up to 320 km/h (199mph) on this route.

日本的 新干线，通常被称为子弹火车，以其速度和高效性而闻名。从 青森 到 函馆 乘坐新干线，体验一段顺畅且激动人心的旅程。在这条路线中，E5系列新干线的最高时速可达 320公里/小时（199英里/小时）。

Seikan Tunnel Crossing
青函海底隧道



Culinary Arrangement 饮食安排



Days 天数	BREAKFAST 早餐	LUNCH 午餐	DINNER 晚餐
1	-	Sukiyaki buffet/Shabu Shabu	酒店晚餐 Hotel Dinner
2	酒店早餐 Hotel Breakfast	富士屋御膳 Fujiyā Meal	酒店晚餐 Hotel Dinner
3	酒店早餐 Hotel Breakfast	FUMOTOYA芭蕉定食 FUMOTOYA Bashō Meal	仙台名物牡蛎牛舌套餐 Sendai Oyster and Ox Tongue Meal
4	酒店早餐 Hotel Breakfast	天妇罗荞麦面 Tempura Soba	酒店晚餐 Hotel Dinner
5	酒店早餐 Hotel Breakfast	烧鱼定食 Grilled Saba Set	居酒屋料理 Izakaya Cuisine
6	酒店早餐 Hotel Breakfast	日式BBQ Japanese BBQ	酒店晚餐 Hotel Dinner
7	酒店早餐 Hotel Breakfast	三文鱼烧锅 Grilled Salmon Hot Pot	三大蟹宴吃到饱 Three Major Crab all you can eat
8	酒店早餐 Hotel Breakfast	田原自助/日式定食 Tahara Buffet/Japanese meal	拉面街任吃 Ramen Street
9	酒店早餐 Hotel Breakfast	-	-

Remarks/备注:

All pictures in brochure are for illustration purpose only/行程上的图片仅供参考

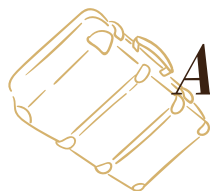

Accommodation 旅宿

☆☆☆☆☆



Hotel Sunshine Kinugawa

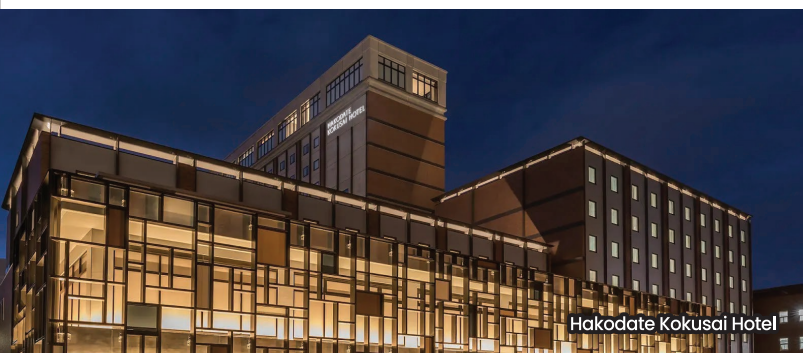

Hakodate Kokusai Hotel



Sendai Washington Hotel

STAY 留宿	LOCATION 地点	HOTEL 酒店	RATED 等级
1 Night	Tochigi	Hotel Sunshine Kinugawa or similar	
1 Night	Aizuwakamatsu	Ashinomaki Grand Hotel or similar	
1 Night	Sendai	Sendai Washington Hotel or similar	★★★★★
1 Night	Morioka	Art Hotel Morioka or similar	★★★★★
1 Night	Aomori	Hotel JAL City Aomori or similar	★★★★★
1 Night	Hakodate	Hakodate Kokusai Hotel or similar	★★★★★
2 Nights	Sapporo	Sapporo Prince Hotel or similar	★★★★★



Hotel JAL City Aomori



Ashinomaki Grand Hotel

THE SIGNATURE TOURS

Sister Brand of



Travel Partner:



thesignaturetours



The Signature Tours 卓越旅程



The Signature Tours